



# JETPARK

AUCKLAND AIRPORT HOTEL  
& CONFERENCE CENTRE

**HOTEL COMPENDIUM**





# AUCKLAND'S MĀNGERE

## ART, IDENTITY, AND AROHA

Auckland's Māngere is the perfect place to unwind, before or after your journey. JetPark Hotel Auckland makes it even easier – offering comfortable rooms, warm hospitality, and everything you need to feel rested and refreshed.

Whether you're arriving or departing, Let JetPark Hotel Auckland take the stress out of travel, so you leave feeling well-rested and ready for your next adventure.





Kia Ora and welcome to JetPark Hotels Auckland.

On behalf of our entire staff, we would like to welcome you to our property. We are thrilled that you have chosen to stay with us and look forward to providing you with a memorable experience.

If you are looking to step out and explore the area, our hotel is conveniently located within a short distance of a variety of popular local attractions and transport options. You can find more details on everything the local area has to offer from our reception team.

Planning on staying in? Try our delicious menu items on offer at Flying Fish Restaurant and Lat Bar.

Do not hesitate to contact our reception team if you need anything during your stay, we will be more than happy to assist you in any way we can.

Kind regards,

Ricard Gamlin  
Group General Manager



# JETPARK AUCKLAND HOTEL & CONFERENCE CENTRE

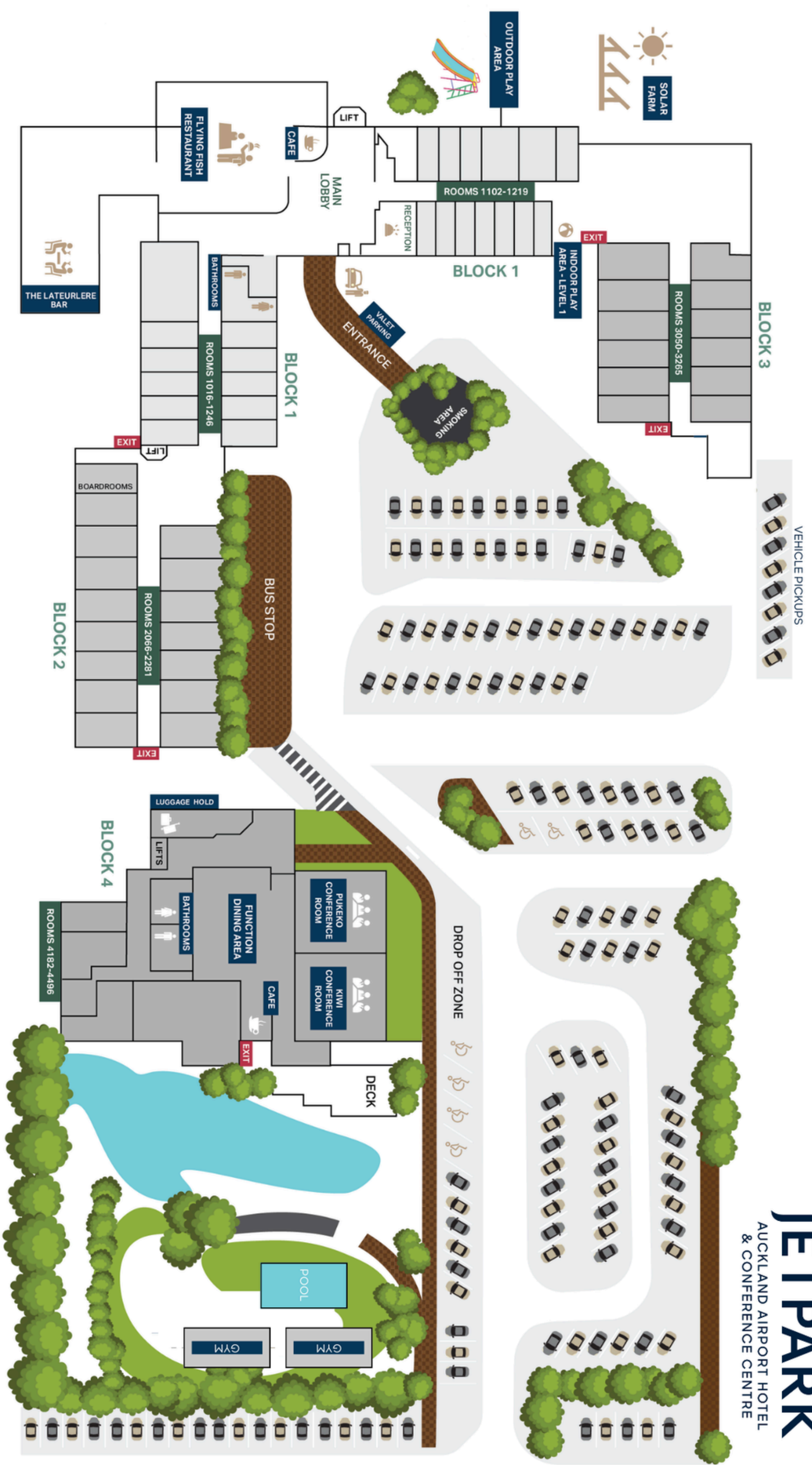

# HOTEL SERVICES

## A-Z DIRECTORY

### A

---

#### Air-Conditioning

Your room has climate control air-conditioning. Please use the remote control to operate the unit. Remote control functions:

 Auto Cool-Heat    Cool    Dry    Heat    Fan

Please contact reception for further instructions. Dial 0

### B

---

#### Baby Facilities

Cots and baby baths are available from Housekeeping.

#### Bath Towels

For additional bath towels, please contact Housekeeping.

#### Banking

The Mangere town centre is in close proximity to the hotel and has a range of major banks, and so is Auckland Airport. The Bank of New Zealand is the nearest available bank, and an ATM is located at 1 John Goulter Drive, Auckland Airport, Auckland 2022.

#### Bar

The Lateurlere Bar, located near the hotel lobby, has a range of beverages for sale, including an NZ wine list. Beverages are available for sale from 11 am to 11 pm, along with our all-day menu.

#### Blankets

There is a blanket in the cupboard, with additional blankets available from Housekeeping.



## **Book Library**

There is a book library on the level 2 Block 1 for you to enjoy. Help yourself or feel free to exchange a book.

## **Breakfast**

Breakfast is available from 6.30 am until 10.30 am daily in the Flying Fish Restaurant.

# **C**

---

## **Cafe**

Kōura Café open from 6 am to 10 pm and is situated in the hotel lobby

## **Checkout Time**

Our checkout time is 11 am. If you wish to check out later than 11 am, please contact Reception. (Dial 0)

## **Children's Indoor Play area**

There is a small dedicated reading and play area on the 1st floor lobby. Children must be supervised at all times. (Dial 0)

## **Children's Outdoor Play area**

There is a small play area outside. Children must be supervised at all times. (Dial 0)

## **Courier Services**

For prompt and fast courier services, please contact Reception.

## **Credit/credit cards**

JetPark Hotel welcomes the use of all major credit cards: Visa, Mastercard, American Express, JCB, and Union Pay. Charge back authorisations are available by prior arrangement.

Dial 0

# **D**

---

## **Dinner**

Flying Fish Restaurant has an all-day dining menu available from 12 pm-10 pm.



# E

---

## Electricity

The power in New Zealand is 240 volts. Adapters for electrical appliances are available from Reception- subject to availability. A \$20 bond will be placed on your account. (Dial 0)

## Emergencies/Fire

The hotel is equipped with fire prevention equipment. FIRE EXIT locations are mounted above the light switch. In the event of a false alarm activated by smoking, the hotel reserves the right to recover any substantial costs. Please familiarise yourself with the information provided. For assistance contact Reception (Dial 0)

## EV Charger

We offer four EV charging stations in clearly marked parking spaces at JetPark Auckland. Chargers are available from reception, simply return them once your vehicle is fully charged. Just another way we're supporting sustainable travel.

# G

---

## Gym

Stay fit while travelling! Get complimentary access to our on-site gym, which is open from 6.00 am - 10.00 pm. Your key card gives you easy access.

# H

---

## Hotel Dresscode

A reasonable standard of dress is required at all times. In the public areas, a minimum requirement is smart casual wear.

## Housekeeping Services

Servicing of the room is done every second day unless otherwise requested. If you have any inquiries, please contact Housekeeping.



# I

---

## **Internet Access**

Unlimited internet access is complimentary to all guests throughout the hotel. Please see the Internet Access details page at the rear of this compendium for further instructions. (Dial 0)

## **Ironing Facilities**

There is an ironing board and an iron situated in your wardrobe. For additional requirements, please contact Housekeeping.

# L

---

## **Lost & Found**

All items that have been found are held by Housekeeping for a period of three months. If you have lost or mislaid any of your personal belongings, please contact Housekeeping or Reception. (Dial 0)

# M

---

## **Mail**

Mail can be forwarded by Reception. On checking out, please leave a forwarding address if mail is expected. (Dial 0)

# N

---

## **Non-Stop Free Direct Airport Shuttle Service**

Enjoy the convenience of non-stop free direct shuttle service between the hotel and Auckland Airport. Our shuttle can experience very busy periods; during peak hours our shuttle can take up to 40 minutes to arrive at the drop-off/pick-up area and may be impacted by airport traffic congestion.

Please note, this service is available for individual guests only. For group shuttle arrangements, our friendly Reception team will be happy to assist you.



## Maintenance

Please report any malfunctions in your room to Reception. (Dial 0)

## Messages

Guest messages will be left in your room. Contact Reception for assistance. (Dial 0)

# P

---

## Parking & Car Storage

Book your accommodation directly on our website and enjoy 10 days of free parking as part of your stay!

Need more time? It's just \$8 per day after that (minimum 4 day charge applies).

Enjoy peace of mind knowing your car is secure and make the most of our complimentary non-stop direct 24/7 airport shuttle for a smooth, stress-free connection to your flight!

## Privacy

If you do not wish to be disturbed, please place the "Chasing Clouds" sign on your outside door handle.

# R

---

## Room Service

Please refer to the in-room dining menus on your in-room television.

# S

---

## Safes

A secure safe is available to store large items at Reception- on request. There are safes in each guest room. Instructions on how to use are located on the safe door. (Dial 0)



## Smoking

Jet Park Hotel is smoke-free in all indoor areas. Smoke detectors can be extremely sensitive. In the event of a false alarm being activated by smoking, the hotel reserves the right to recover the substantial costs. Smoking in rooms carries a fine of \$230. Tampering with the fire system carries a fine of \$500. A designated smoking area is available outside block 2.

## Swimming Pool

Our outdoor heated swimming pool is open daily from 6.00 am - 10.00 pm, perfect for an energising morning dip or a soothing evening swim. Your key card gives you easy access.

# T

---

## Taxi

24 hours taxi service can be arranged through the Reception (Dial 0)

# TOILETRIES

All toiletries including shaving and dental kits are available from Reception. (Dial 0)  
All large in-room dispensers are for guest use, if you wish to take this away with you, an additional charge will be incurred.



## KOURA BODY

Infused with the steam distilled extracts of anti-oxidant rich Kowhai and native Kawakawa leaf. Products can be purchased from Reception (Dial 0) \$15 per product

Koura Hand Wash 300ml ● Koura Body Wash 300ml ● Koura Hand & Body Balm 300ml



# TV CHANNELS

Please refer to our full list of television channels. Should you experience any problems regarding the operation of your television, please contact Reception. (Dial 0)

## TV Channel Directory

Channel 1	TVNZ 1
Channel 2	TVNZ 2
Channel 3	Three
Channel 4	Bravo
Channel 5	Maori TV
Channel 6	TVNZ 1 + 1
Channel 7	TVNZ 2 + 1
Channel 8	ThreePlus1
Channel 9	Bravo PLUS 1
Channel 10	Prime
Channel 11	Sky Sport 1
Channel 12	Premiere Movies
Channel 13	Nickelodeon
Channel 14	Discovery
Channel 15	BBC UKTV
Channel 17	HGTV
Channel 19	TVNZ Duke
Channel 20	Eden
Channel 22	Hope Channel
Channel 24	Chinese TV
Channel 27	Al Jazeera
Channel 28	Rush
Channel 29	Shine TV
Channel 30	Firstlight
Channel 31	Parliament
Channel 32	Radio NZ Concert
Channel 33	Radio NZ National



# TV CHANNELS

Please refer to our full list of television channels. Should you experience any problems regarding the operation of your television, please contact Reception. (Dial 0)

## TV Channel Directory

Channel 1	TVNZ 1	Channel 18	C33
Channel 2	TVNZ 2	Channel 19	Hope Channel
Channel 3	Three	Channel 20	Chinese TV
Channel 4	Maori TV	Channel 21	Panda
Channel 5	TVNZ 1 + 1	Channel 30	Sky Sport 1
Channel 6	TVNZ 2 + 1	Channel 31	Sky Sport 2
Channel 7	Three Plus1	Channel 32	Sky Sport 3
Channel 8	Prime	Channel 33	Sky Sport 4
Channel 9	Choice TV	Channel 34	Sky 5
Channel 10	Parliament	Channel 35	Sky Movies Family
Channel 11	Te Reo	Channel 36	Sky Movies Classic
Channel 12	TVNZ Duke	Channel 37	Sky Movies Premier
Channel 13	TVNZ Duke +1	Channel 40	Radio NZ National
Channel 14	Discovery	Channel 41	Radio NZ Concert
Channel 15	Al Jazeera	Channel 42	Radio George FM
Channel 16	CNN	Channel 43	Base FM
Channel 17	Bravo	Channel 50	Jet Park Hotel

## W

---

### Wake Calls

Wake up calls can be arranged through the Reception (Dial 0) Alternatively, you may wish to program the alarm clock next to your bed.



# APPENDIX

## LOCAL AND USEFUL INFORMATION

---

### INTERNET ACCESS

Wireless internet access is available in all rooms.

Wi-Fi Access in your room:

- Make sure your Wi-Fi on your device is enabled and connect to “JetParkGuest”
- Once connected, "Sign in" to the JetPark Guest page and fill the fields below
- Your room number
- Login code: password available from Reception

### CORDLESS PHONE OPERATION

- Your phone can be used anywhere within the hotel
- To make a call, dial 9 for an outside line
- Then dial the desired number you wish to call
- To call a room, dial 7 followed by the room number. Example: To call room 002 dial 7002
- If you require any assistance with your handset, please contact Reception (Dial 0)



# LOCAL & INTERNATIONAL CALLING

Directory	9 then 018
Assistance	9 then the number
Local and National Calling	9 then the national area code then the number

## National Area Codes

Ashburton	03	Oamaru	03
Auckland	09	Palmerston North	06
Blenheim	03	Queenstown	03
Christchurch	03	Rotorua	07
Dunedin	03	Russell	09
Gisborne	06	Taupo	07
Greymouth	03	Tauranga	07
Hamilton	07	Timaru	03
Hibiscus Coast	09	Whanganui	06
Invercargill	03	Wellington	04
Levin	06	Westport	03
Napier	06	Whangarei	09
Nelson	03		
New Plymouth	06		



# EXPLORE AUCKLAND'S MĀNGERE



# EXPLORE MĀNGERE

## **Māngere Arts Centre - Ngā Tohu o Uenuku**

Located only minutes away from the hotel, The centre is the home of Māori and Pacific visual and performing arts in Auckland.

[Māngere Arts Centre](#)



## **Māngere Mountain**

Te Pane o Mataoho / Te Ara Pueru is one of Auckland's many volcanic cones. The volcano erupted about 18,000 years ago. Access the maunga from Domain Road. The summit gates are open from 7am to 8.30pm in summer, and 7am to 7pm in winter.

[Māngere Mountain](#)



## **Māngere Market**

Mangere Market has become the showplace for New Zealand's multi cultural shopping experience. Produce and merchandise from around the world is displayed weekly in a family environment.

[Māngere Māngere Market](#)



# EXPLORE MĀNGERE

## Otuataua Stonefields

Ōtuataua Stonefields is a 100-hectare site of significance to mana whenua. It was established to protect and preserve the archaeological remains of the communities which thrived on this land for hundreds of years.

[Otuataua Stone Fields](#)



## Ambury Regional Park

Ambury Farm lies along the coast of the Manukau Harbour in the suburb of Māngere Bridge. You can take in various farm animals as you wander around the farm. This is a significant habitat for shorebirds and the coast has examples of basalt lava flows.

[Ambury Regional Park](#)



## Māngere Bridge

Fantastic award-winning shared public space place to walk, run, bike or fish. This bpeditraian bridge is 260m long and 8m wide with a stunning 60m steel tie-arch

[Māngere Bridge](#)



# EXPLORE MĀNGERE

## Māngere Mountain Education Centre

Walk the present and discover the past with local indigenous Māori tribal people from Māngere Mountain - one of Auckland's most significant landforms.

[Māngere Mountain Education Centre](#)



## Te Araroa Trail

The Te Araroa Trail is a 3,000-kilometer (1,864-mile) long-distance walking track that runs the length of New Zealand, from Cape Reinga in the north to Bluff in the south. The 23.3Km trail section between Onehunga and Puhinui Creek has access nearby.

[Te Araroa Trail](#)



## Mānawa Bay Shopping

Mānawa Bay offers more than 100 iconic stores, the widest selection of brands, all with exceptional savings to choose from. Open daily 10am -7pm

[Mānawa Bay Shopping](#)





TIAKI MEANS TO CARE FOR PEOPLE AND PLACE. THE TIAKI PROMISE IS A COMMITMENT TO CARE FOR NEW ZEALAND, FOR NOW AND FOR FUTURE GENERATIONS.

NEW ZEALAND IS PRECIOUS, AND EVERYONE WHO LIVES AND TRAVELS HERE HAS A RESPONSIBILITY TO LOOK AFTER IT.

BY FOLLOWING THE TIAKI PROMISE, YOU ARE MAKING A COMMITMENT TO NEW ZEALAND. TO ACT AS A GUARDIAN, PROTECTING AND PRESERVING OUR HOME.

NAU MAI, HAERE MAI KI AOTEAROA, WELCOME TO NEW ZEALAND.

TIAKINEWZEALAND.COM | #TIAKIPROMISE



# TIAKI PROMISE

— WHILE TRAVELLING IN NEW ZEALAND I WILL —

CARE FOR LAND, SEA AND NATURE,  
TREADING LIGHTLY AND LEAVING NO TRACE

TRAVEL SAFELY, SHOWING CARE  
AND CONSIDERATION FOR ALL

RESPECT CULTURE, TRAVELLING  
WITH AN OPEN HEART AND MIND

— HOW TO CARE FOR NEW ZEALAND —



PROTECT  
NATURE



KEEP NZ  
CLEAN



DRIVE  
CAREFULLY



BE  
PREPARED



SHOW  
RESPECT



63 Westney Drive, Mangere, Auckland

Contact Us: 0800 538 466

Email: [reservations@jetpark.co.nz](mailto:reservations@jetpark.co.nz)

[www.jetparkauckland.co.nz](http://www.jetparkauckland.co.nz)

